

Breakout Session 3
Pollen counting – A
quantitative measurement
mode for highest precision



Counting mode



- Introduced with AmphaSoft 2.1.5
 - Mode activated in measurement list
 - Does not work with Autosampler
 - Autocalibration feature is off (in AmphaSoft 2.1.6)
 - Quantitative method for assessing cell concentration or performing a total cell count analysis with highest accuracy and precision
 - All cells in the sample tube are counted (tube is emptied in any case)
 - For cell concentration:
 - ▶ Exact sample volume in sample tube must be known
 - ▶ Exact volume set as μl stop condition
 - For total cell count:
 - ▶ Any sample volume in sample tube possible
 - ▶ Any volume set as μl stop condition
- Make sure all sample has been aspirated (no residual liquid in sample tube)

Loading and Measuring: Normal measurement

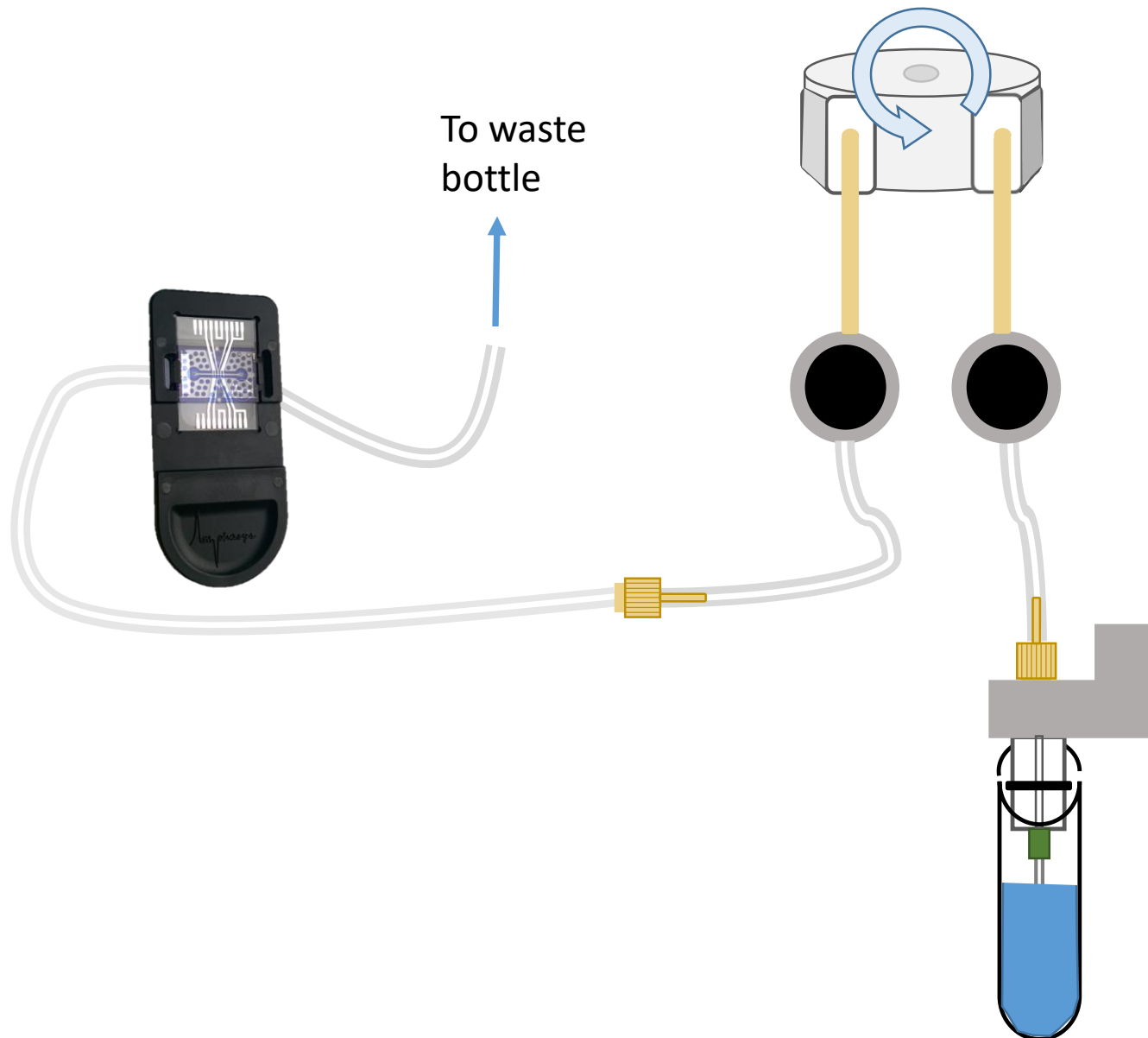

Loading Phase: Counting mode measurement

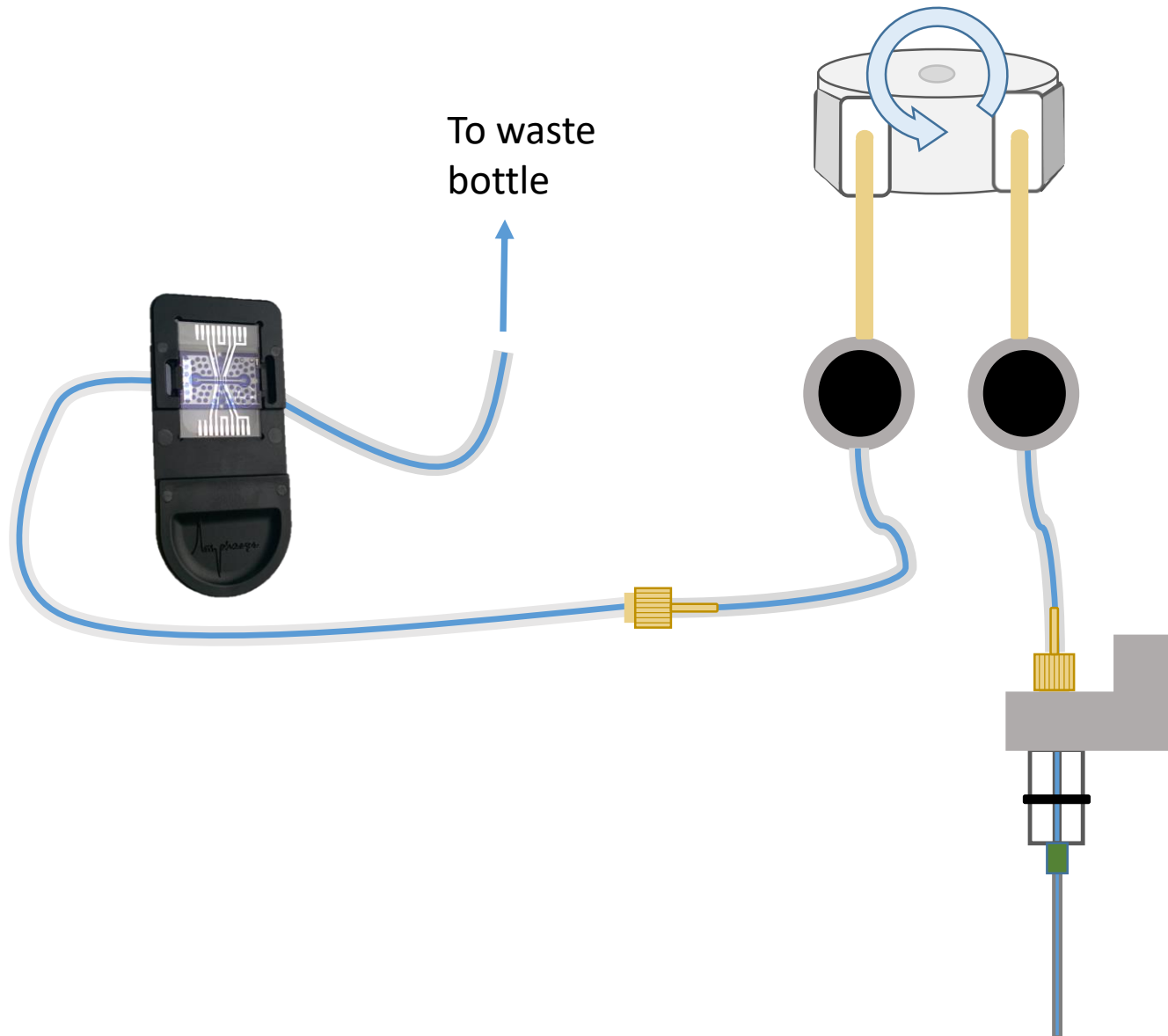

Measurement during counting mode measurement

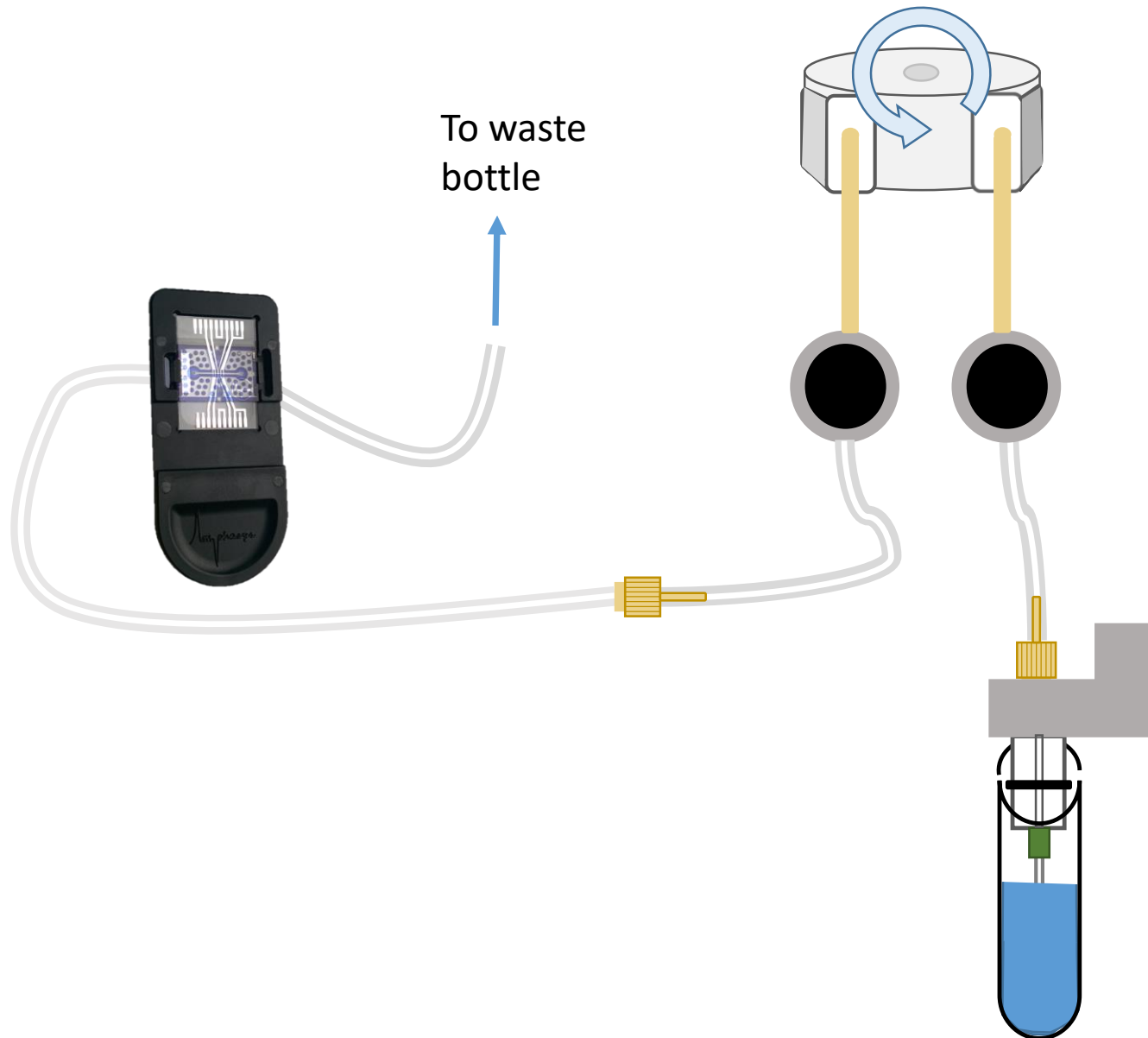

Measurement during counting mode measurement

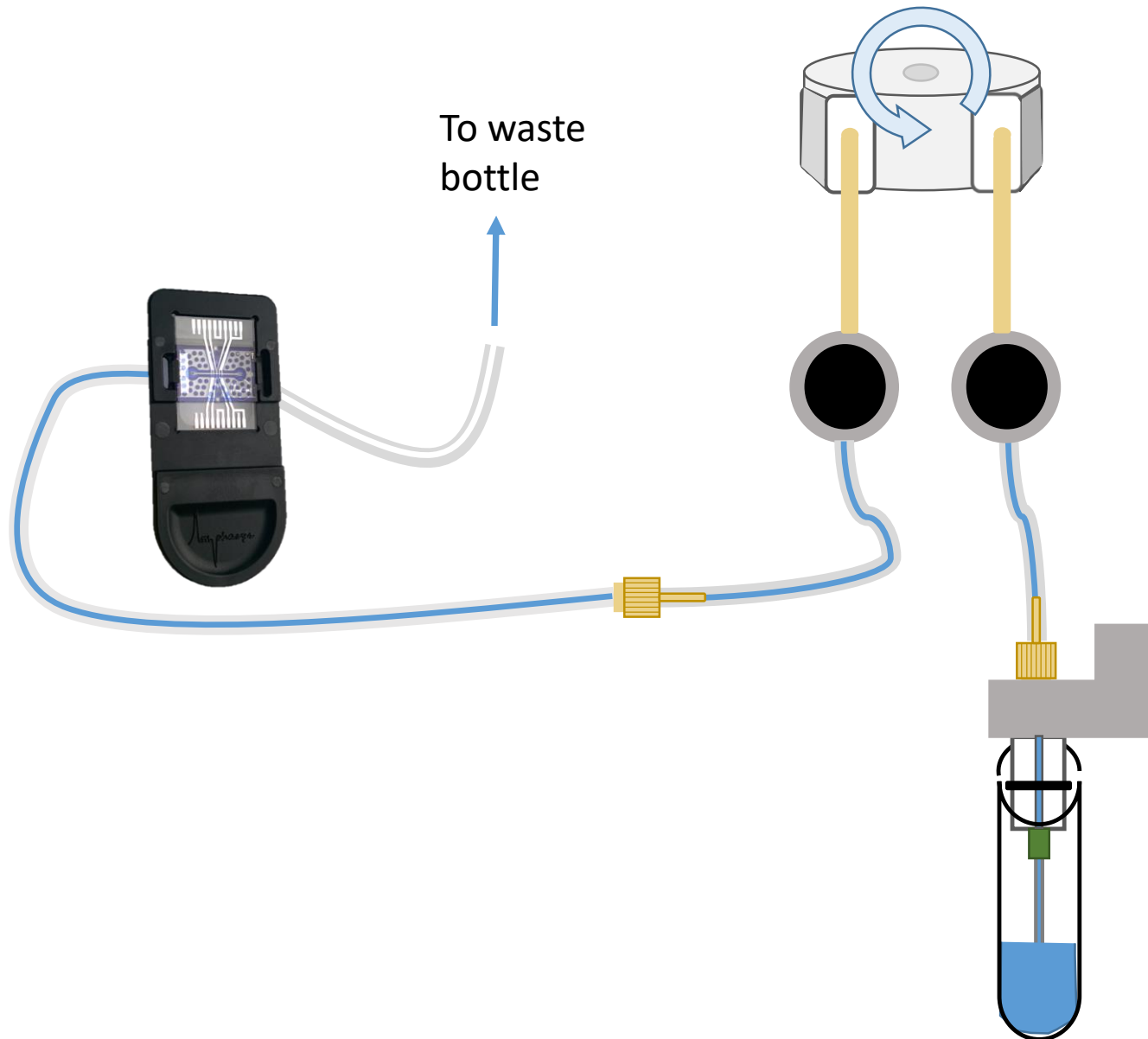

And now: Hands on

